

2.4GHz Wireless Dimming (RGB+CCT)

Model No.: PUSH1

Features

- AC100-240V powered
- No wiring required, easy to implement PUSH switch to wirelessly control the color, CCT, brightness and switch of lights.
- Compatible with MiBoxer / Mi-Light 2.4G series lamps.
- Using 2.4G RF wireless transmission technology, the control distance is 30 meters, and the number of lamps is unlimited.
- Supports 4096 levels of smooth dimming, the lowest brightness is 0.1%.
- Dimming range: 0.1%-100%



Product Parameters

Product Name:	2.4GHz Wireless Dimming (RGB+CCT)
Model No.:	PUSH1
Input Voltage:	AC100-240V 50/60Hz
Transmitting Power:	6dBm
RF:	2.4GHz
Control Distance:	30m
IP Rating:	IP20
Working Temperature:	-10~40°C
Standby Power Consumption:	0.15W

Dimming Grayscale:	4096 Levels
Dimming Range:	0.1%-100%
EMC Standard (EMC):	ETSI EN 301 489-1 V2.2.3 ETSI EN 301 489-3 V2.1.1
Safety Standard (LVD):	EN 61347-1: 2015+A1:2018 EN 61347-2-11: 2001+A1:2019
Radio Equipment (RED):	ETSI EN 300 440 V2.2.1
Certification::	CE, EMC, LVD, RED

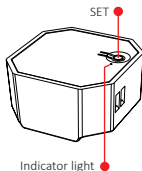
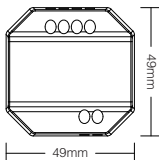
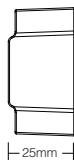

Connection Diagram

PUSH Switch
(Requires separate purchase)

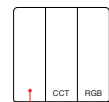

ON / OFF / Brightness

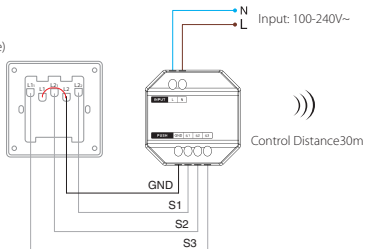

MiBoxer 2.4G
Series Lighting
and Controllers

Installation Diagram

Support following standing junction box

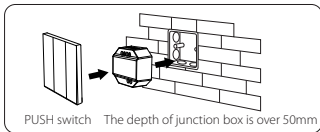
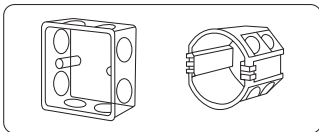

Linking Code Instructions

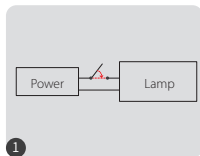

Power off, then power on again after 10 seconds

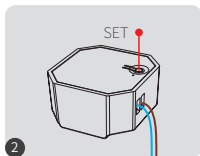

Short press the "SET" 3 times within 3 seconds



The lamp flashes slowly 3 times, indicating successful linking



If the lamp does not flash slowly, the code binding failed, please re-perform the above steps.
(Note: Already coded lamps cannot be coded again).

Unlinking Code Instructions

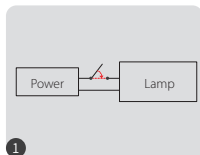

Power off, then power on again after 10 seconds

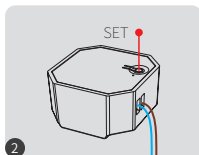

Short press the "SET" 5 times within 3 seconds



The lamp flashes quickly 10 times, indicating successful unlinking



If the light does not flash quickly, the code clearing failed, please perform the above steps again.
(Note: Already coded lamps cannot be coded again)。

Dimming control

ON/OFF/Brightness

Short press to turn on/off the light, long press to adjust the light brightness.

CCT

Short press to switch to white light, long press to adjust color temperature.

RGB

Short press to switch to colored light, long press to adjust the light color.

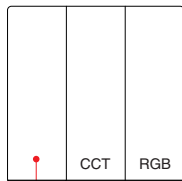

ON / OFF / Brightness

Notice

1. Please do not use it in a humid or high temperature environment for a long time. When not in use for a long time, please remove the battery and store it in a dry, static-free environment.
2. Do not use it in an environment with a large area of metal or near strong electromagnetic waves, otherwise the control distance will be seriously affected.



Made in China