

Smart Switch (2.4GHz)

Model No.: SWR

Features

- Used to turn on/off LED lights (without dimming function), traditional incandescent lamps, halogen lamps, heaters, electric fireplaces and other traditional appliances
- One controller can be paired with 12 remote (control distance 30m)
- With 2.4G RF two-way communication function, it needs to be used with C2 remote control
- Auto-forwarding: Auto-forward the remote signal to another switch, making the remote control distance infinite
- Support PUSH switch or rocket switch control
- Supports "Tuya Smart" app control (2.4GHz gateway is needed)
- Support Alexa, Google Assistant, Yandex Alice (2.4GHz gateway is needed)



Parameters

Product Name:	Smart Switch (2.4GHz)	Control Signal:	2.4G + PUSH
Model No.:	SWR	2.4G Control Distance:	30m
Input Voltage:	AC100~240V 50/60Hz	WiFi Standards:	IEEE 802.11b/g/n 2.4GHz
Output Voltage:	AC100~240V 50/60Hz	EMC Standard (EMC):	ETSI EN 301 489-1 V2.2.3 ETSI EN 301 489-17 V3.2.4
Output Current:	Max 10A	Safety Standard (LVD):	EN 62368-1: 2020 + A1: 2020
Output Power:	1000W-2400W	Radio Equipment (RED):	ETSI EN 300 440 V2.2.1
IP Rating:	IP20	Certification:	CE, EMC, LVD, RED
Working Temp.:	-10~40°C		

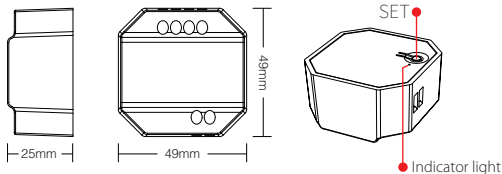

Connection Diagram

Method 1

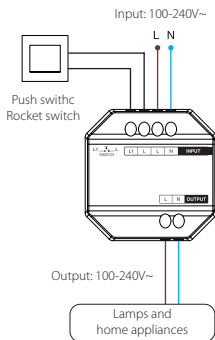

Method 2

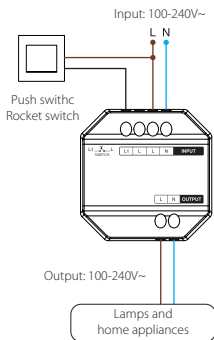

Application Diagram

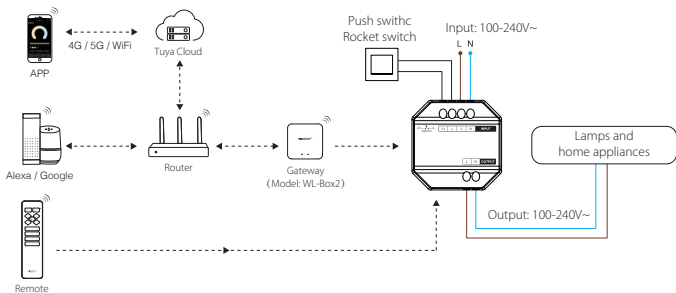

Installation Diagram

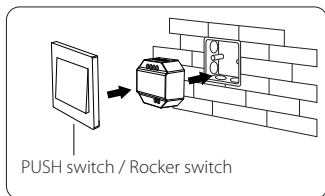

Support following standing junction box,
The depth of junction box is over 50mm

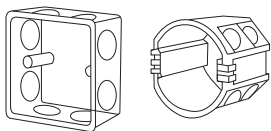

Compatible with remote control (need to be purchased separately)

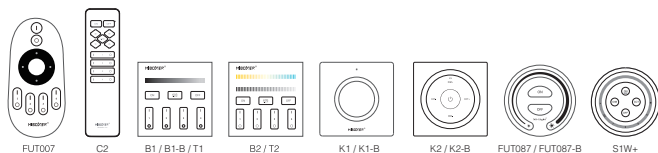

Linking Code Instructions

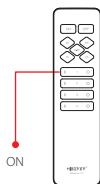
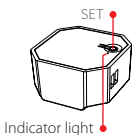

1). Activating unlinking mode

- 1: short press "SET" 1 time, indicator breathing.
- 2: power off dimmer 10 seconds, power on again.
- 3: (PUSH switch / Rocker switch) change "OFF" into "ON".

2). Press " | " in any group zones 3 times within 3 seconds, linking is done.

Unlinking Code Instructions

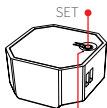

Indicator light

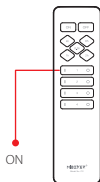

ON

1). Activating unlinking mode

- 1: short press "SET" 1 time, indicator breathing.
- 2: power off dimmer 10 seconds, power on again.
- 3: (PUSH switch / Rocker switch) change "OFF" into "ON".

- 2). Press " | " in correspond group zones 5 times within 3 seconds, unlinking is done.

Attention: Linking or Unlinking must be in same group.

Transmitting function instruction

Devices can transmit signal to another one if there is new device within 30m, countless control distance by auto transmitting.

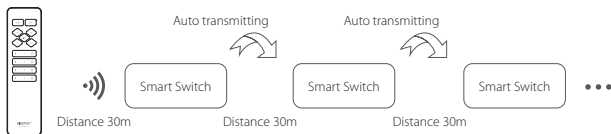

Attention: All "Smart Switch" must be linked with one remote.

Notice

1. Please turn off power supply before installation.
2. Please ensure input voltage to be same as requirements from device.
3. Don't disassemble device if you are not expert, otherwise it will damage it.
4. Please do not use the light in the place with widely range metal area or strong electromagnetic wave nearby, otherwise, the remote distance will be seriously affected.

Made in China



Dimmer can not use in humid area